

El Pomar Youth Sports Park – 2212 Executive Circle, Colorado Springs, CO 80906

Tournament Contacts:

- EMS, 911
- Christina Lorete, Colorado College Campus Recreation Athletic Trainer, 757-286-9568
- Jimmy Donnellon, Tournament Director/Colorado College Men’s Ultimate Coach, 719-200-8422

Equipment

- Located at Medical Tent: Air Splints, AED, all First Aid supplies.

Injury Documentation

- All injuries should be documented utilizing USA Ultimate’s online reporting system:



Nearby Emergency Departments:

- UCHealth Memorial Hospital
1400 E. Boulder St., Colorado Springs, CO
- CommonSpirit Penrose Hospital
2222 Nevada Ave., Colorado Springs, CO 80907

Nearby Urgent Cares:

- UCHealth Urgent Care – Circle Square
2767 Janitell Rd., Colorado Springs, CO 80906
- CommonSpirit Urgent Care – Broadmoor
1263 Lake Plaza Dr. #120, Colorado Springs, CO 80906

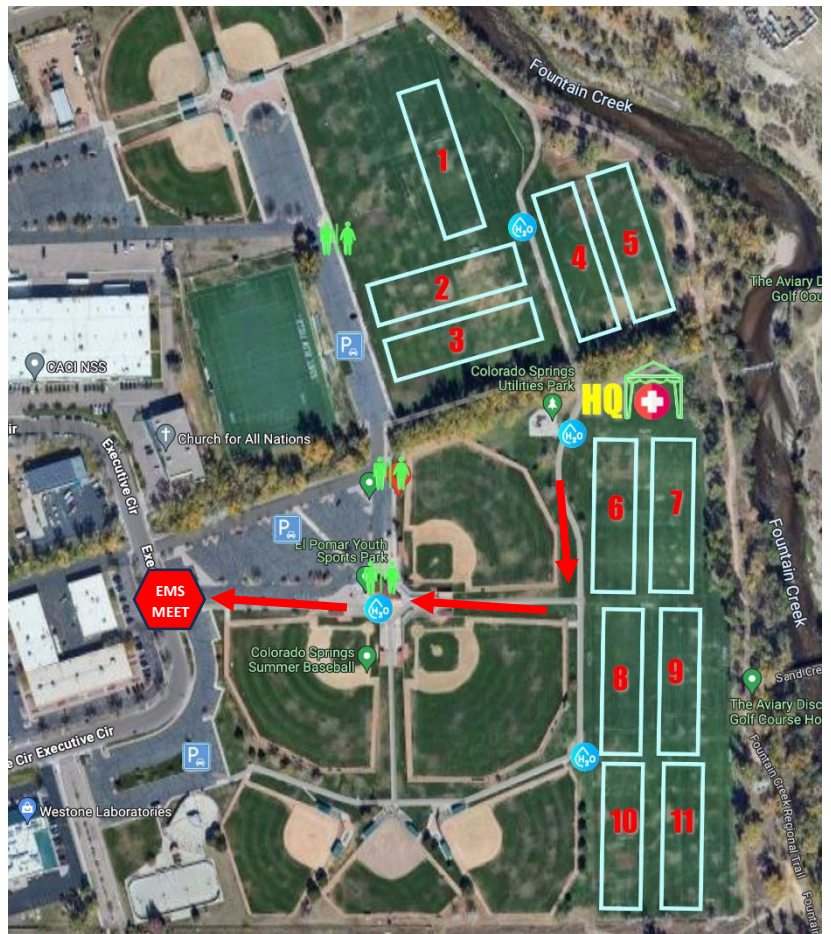

USA ULTIMATE
INCIDENT REPORT FORM

NAME OF INDIVIDUAL COMPLETING FORM _____

INJURED PERSON

ROLE Athlete Coach Volunteer Chaperone

FIRST NAME _____

LAST NAME _____

GENDER Male Female Other

DATE OF BIRTH _____

CONTACT INFO

EMAIL ADDRESS _____

PHONE# _____

STREET ADDRESS _____

CITY _____

STATE _____

POPSTAL CODE _____

PRIMARY INSURANCE

Check if you do not have primary insurance.

INSURANCE CARRIER NAME _____

POLICY HOLDER NAME _____

POLICY # _____

Group # _____

INCIDENT DETAILS

DATE _____

EVENT NAME _____

TEAM NAME _____

PLAYING SURFACE TYPE Grass Indoor Turf Sand

INJURY SPECIFICS

BODY PART

SIDE Left Right Center Not Specified

SEVERITY Report Only Minor Serious Critical

INJURY DESCRIPTION (250 WORDS)

INJURY RESPONSE

Onsite Care Provide Ambulance Taken